

1 2 3 4 5 6

A

B

C

D

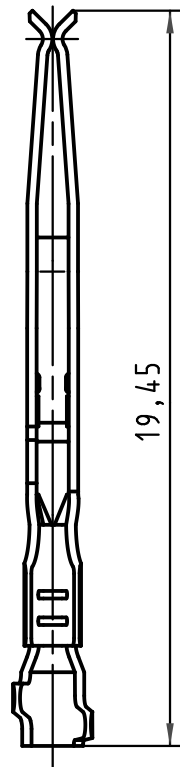
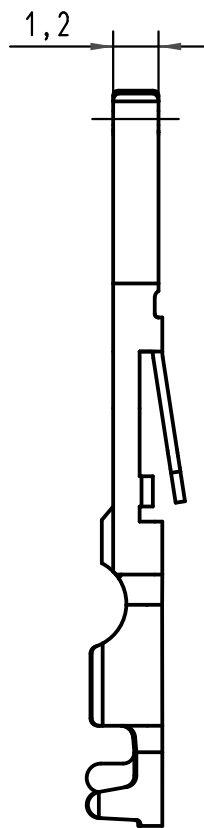

02 05 000 <u>2513</u>	2
02 05 000 <u>1513</u>	1
Bestell-Nr. <i>part-no.</i>	Anforderungsstufe nach IEC <i>performance level acc.to IEC</i>

	All Dimensions in mm Original Size DIN A 4			Techn. Character.			Nicht tolerierte Maßel <i>Free size tolerances</i>	
					Dat.	Name	Maßstab/Scale 5:1	har-bus 64 Crimpkontakt AWG 28-20 (0,09-0,5mm ²) har-bus 64 Crimp-contact AWG 28-20 (0,09-0,5mm ²)
			Detail.	23.04.08	LehT			
			Insp.	23.04.08	Ge			
			Stand.					
35187	06.06.08	LehT	HARTING Electronics GmbH & Co. KG				TB 02 05 000 x513	Blatt/ page
35144			D-32339 ESPELKAMP					
Mod.	Dat.	Name						

Sub.